

Up To 190,000 Square Feet in Conover, North Carolina



PUNCH LOOP ROAD | IMMEDIATE ACCESS TO I-40 AVAILABLE LAND FOR BUILD-TO-SUIT IN CONOVER, NORTH CAROLINA

PROPERTY HIGHLIGHTS

- 19.9 Acres
- Two Buildings
- 80,000 Square Feet | 11 Docks, 2 Drive-ins
- 110,000 Square Feet | 23 Docks, 2 Drive-ins
- Office to suit
- Zoned EM-1 – Exclusive Manufacturing
- Immediate Access to I-40
- 57,500 Vehicles per Day on I-40

For more information, please contact:

BRIAN LENAHAN
Cell: 216.469.6423
brian@premierdevelop.com

5605 Granger Road, Suite 100, Cleveland, Ohio 44131
216.341.1200 | www.premierdevelop.com

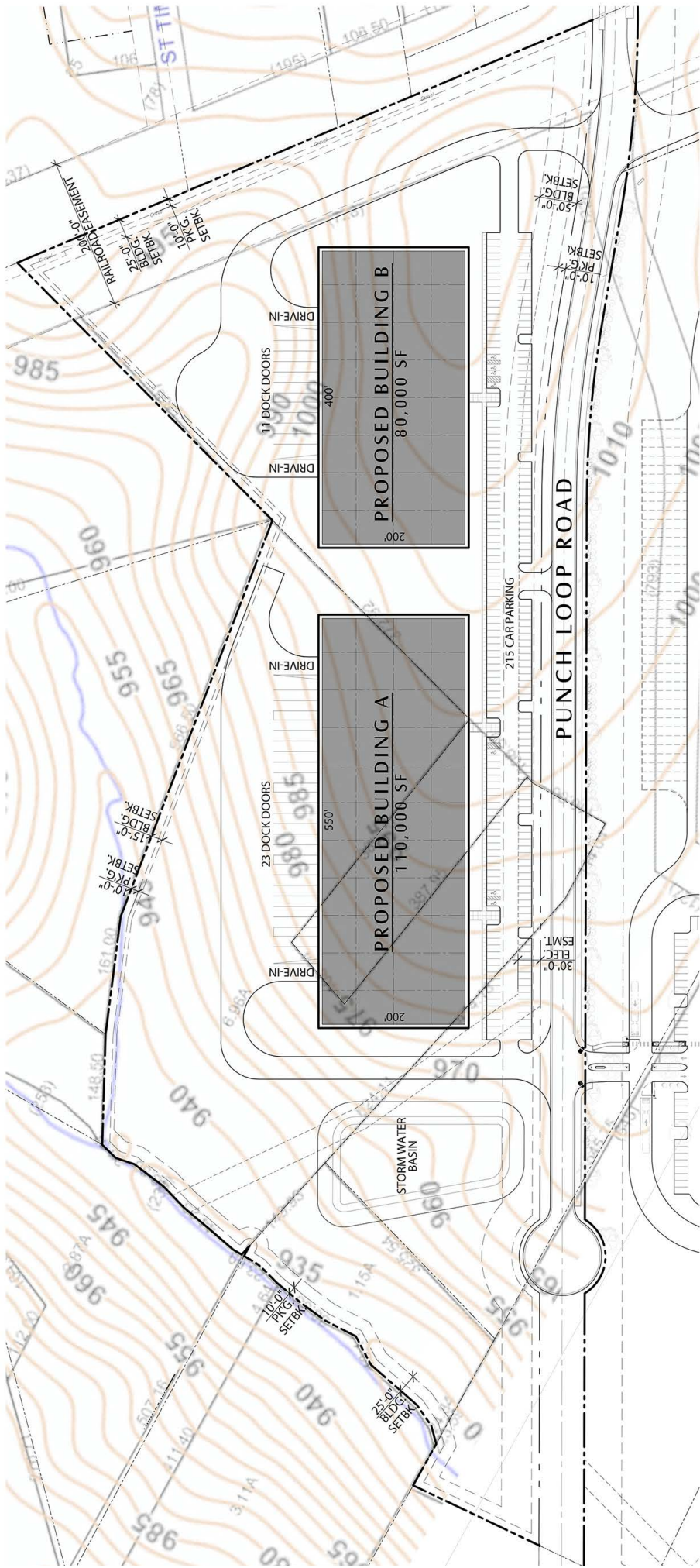

PROJECT SUMMARY

ZONING DISTRICT: EM-T - EXCLUSIVE MANUF.G.

LOT SIZE: 19.9 ACRES

BUILDING STATISTICS:
 BUILDING A AREA: 110,000 SF
 CAR PARKING: 121 SPACES
 DRIVE-IN DOORS: 2 DOORS
 RECESSED DOCKS: 23 DOCKS

BUILDING B AREA: 80,000 SF
 CAR PARKING: 94 SPACES
 DRIVE-IN DOORS: 2 DOORS
 RECESSED DOCKS: 11 DOCKS



MAY 23, 2022
 SITE PLAN

CONOVER - 190

PROPOSED OFFICE / INDUSTRIAL FACILITY
 PUNCH LOOP ROAD, CONOVER, NORTH CAROLINA



22.004

SP.1



DSC ARCHITECTS
 8015 GOLF COURSE DRIVE
 RALEIGH, NORTH CAROLINA 27615