



29001 Solon Road

Solon, Ohio

David R. Hexter, SIOR
Principal

216 455 0890
dhexter@naidaus.com

Jeffrey A. Calig, CCIM
Senior Vice President

216 455 0910
jcalig@naidaus.com

 @jcalig
HexterCalig.com

Property Features

- Space Available: 6,400-32,000 (contiguous SF)

	Unit H	Unit I	Unit K	Unit O	Unit P
Size (SF)	12,800	6,400	12,800	6,400	8,640
Office (SF)	200	0	1,400	400	0
Whse (SF)	12,600	6,400	11,400	6,000	8,640
Docks	2	0	1	2	3
Drive-ins	0	2	4	0	0

- Ceiling Clearance: 20'
- Truck Docks: 8
- Drive-ins: 6
- Sprinklered

NO WARRANTY OR REPRESENTATION, EXPRESS OR IMPLIED, IS MADE AS TO THE ACCURACY OF THE INFORMATION CONTAINED HEREIN, AND THE SAME IS SUBMITTED SUBJECT TO ERRORS, OMISSIONS, CHANGE OF PRICE, RENTAL OR OTHER CONDITIONS, PRIOR SALE, LEASE OR FINANCING, OR WITHDRAWAL WITHOUT NOTICE, AND OF ANY SPECIAL LISTING CONDITIONS IMPOSED BY OUR PRINCIPALS NO WARRANTIES OR REPRESENTATIONS ARE MADE AS TO THE CONDITION OF THE PROPERTY OR ANY HAZARDS CONTAINED THEREIN ARE ANY TO BE IMPLIED.



23240 Chagrin Blvd. Ste. 250
Cleveland, Ohio 44122
216 831 3310
naidaus.com

Units H & I Floor Plan

- ☐ Man Door
- ▭ Drive-ins
- Docks

*Not to Scale

Total 19,200 SF

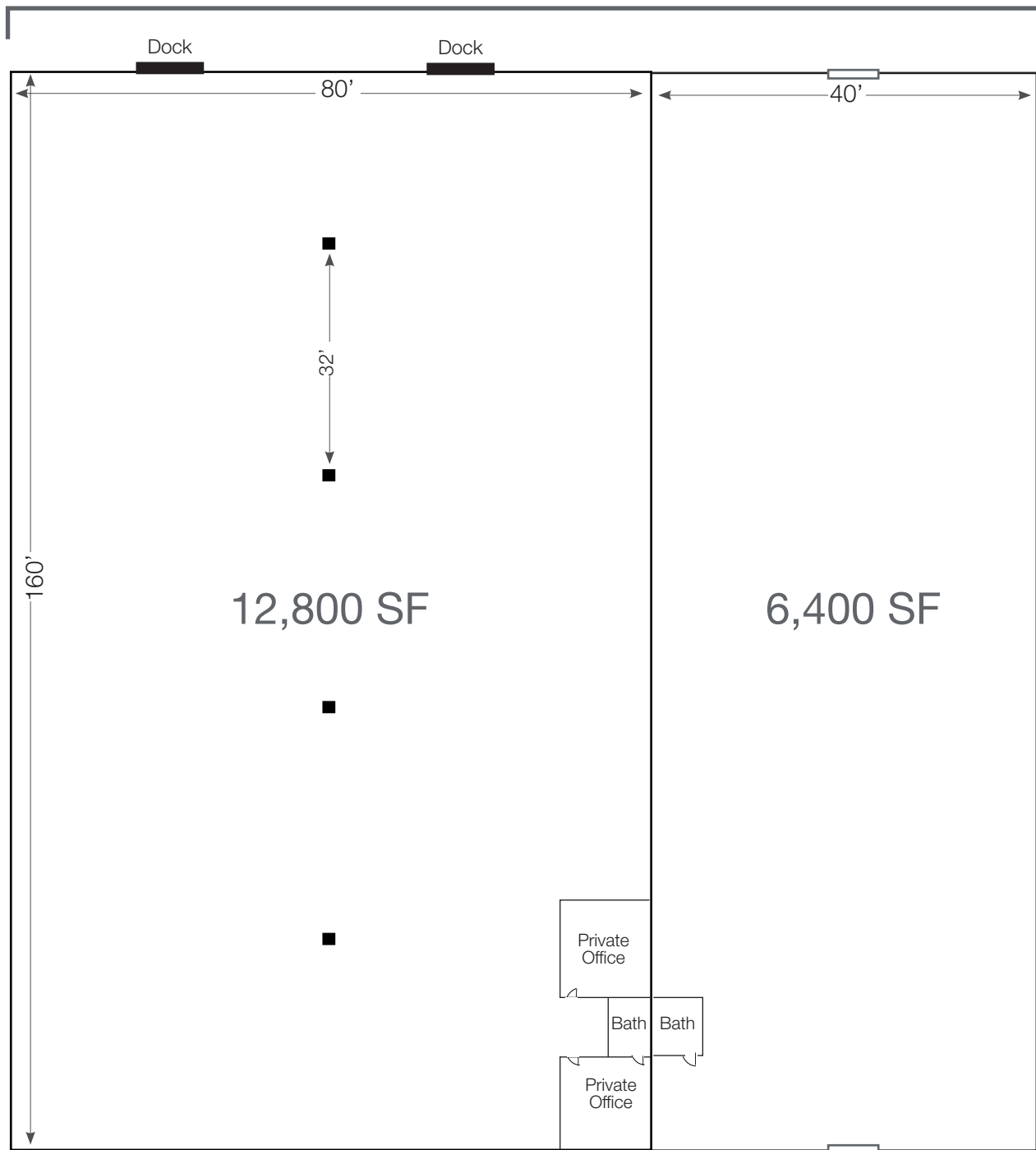

29001 Solon Road

Solon, Ohio

Jeffrey A. Calig, CCIM
Senior Vice President
216 455 0910
jcalig@naidaus.com

David R. Hexter, SIOR
Principal
216 455 0890
dhexter@naidaus.com

NAIDaus

Business Property Specialists Inc. Broker

23240 Chagrin Blvd. Ste. 250
Cleveland, Ohio 44122
216 831 3310

naidaus.com

Unit K Floor Plan

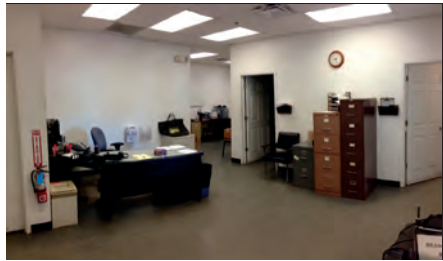
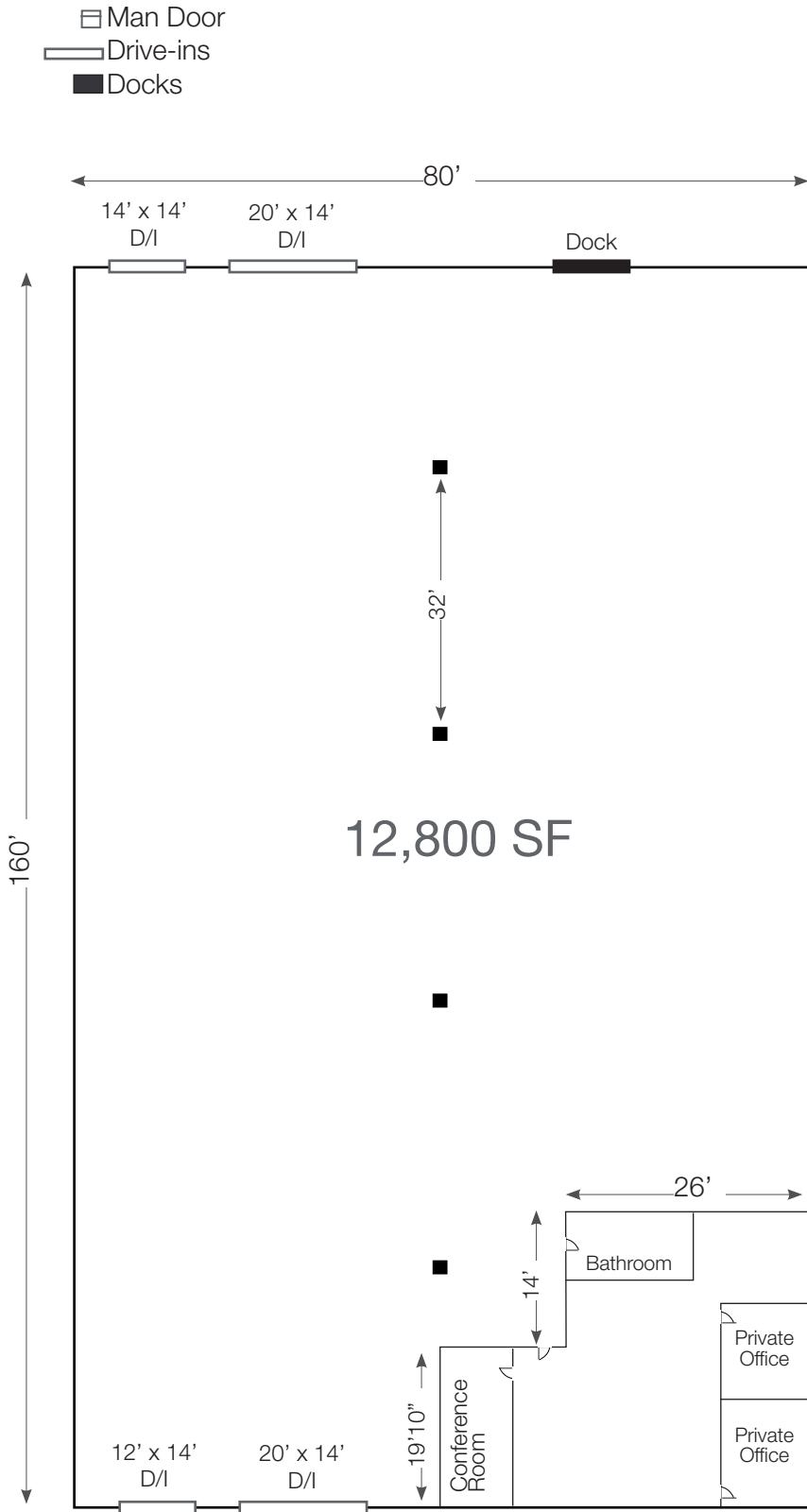

David R. Hexter, SIOR
Principal

216 455 0890
dhexter@naidaus.com

Jeffrey A. Calig, CCIM
Senior Vice President

216 455 0910
jcalig@naidaus.com

@jcalig
HexterCalig.com

29001 Solon Road
Solon, Ohio

*Not to Scale

Unit 0 Floor Plan

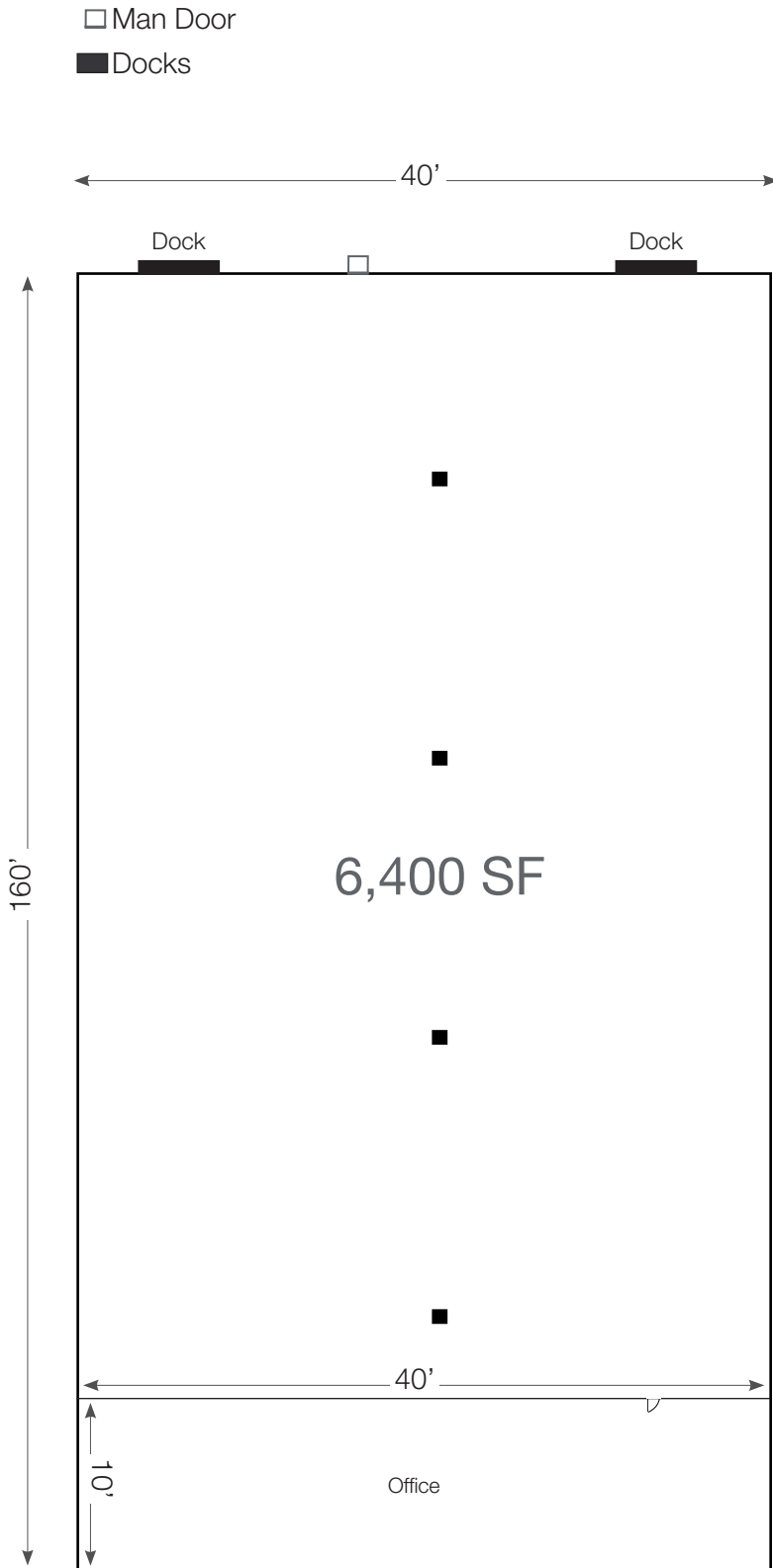

David R. Hexter, SIOR
Principal

216 455 0890
dhexter@naidaus.com

Jeffrey A. Calig, CCIM
Senior Vice President

216 455 0910
jcalig@naidaus.com

 @jcalig
HexterCalig.com

29001 Solon Road
Solon, Ohio

*Not to Scale

Unit P Floor Plan

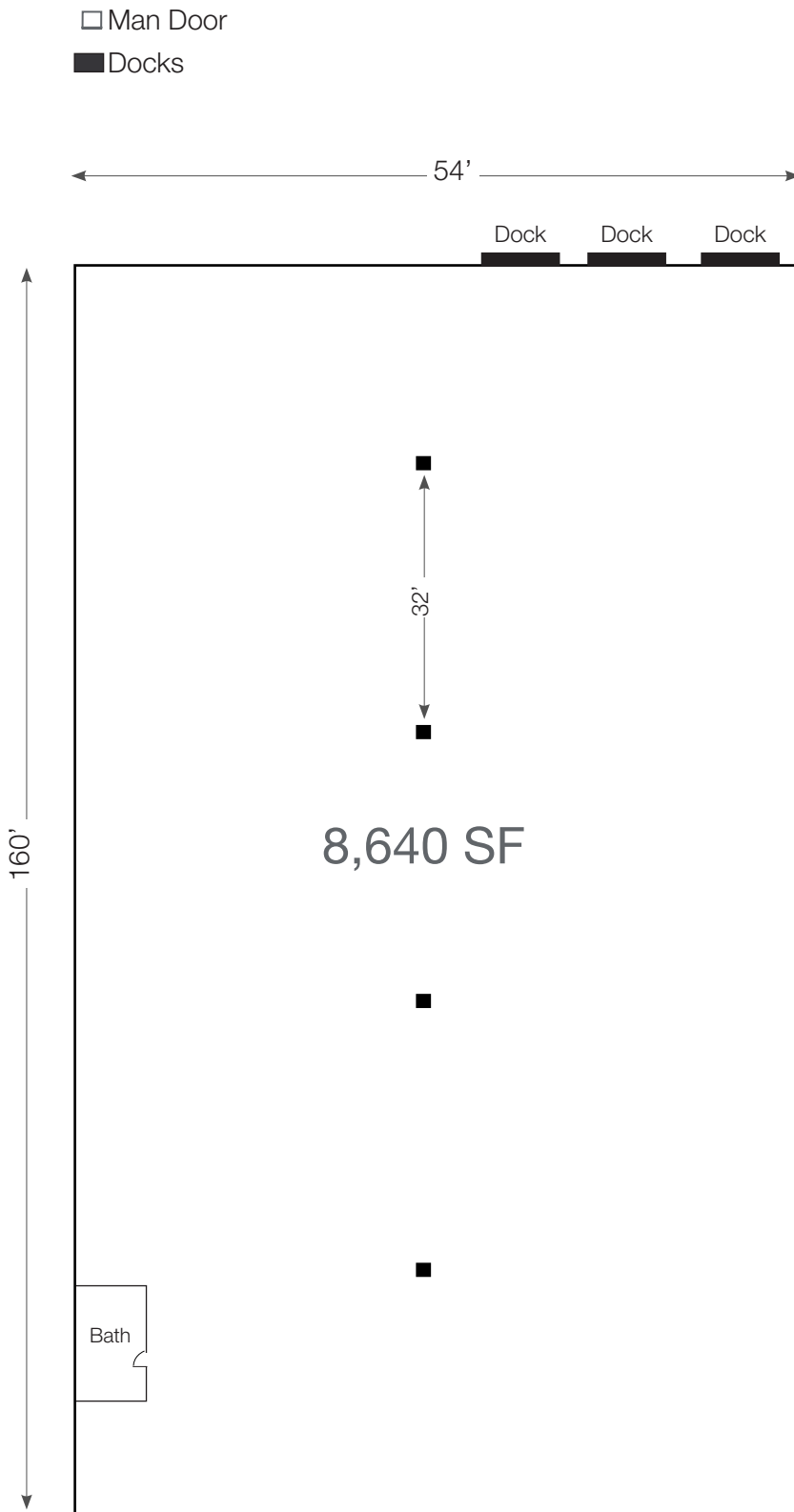

David R. Hexter, SIOR
Principal

216 455 0890
dhexter@naidaus.com

Jeffrey A. Calig, CCIM
Senior Vice President

216 455 0910
jcalig@naidaus.com

 @jcalig
HexterCalig.com

29001 Solon Road
Solon, Ohio

*Not to Scale

BUILDING INFORMATION SHEET

LOCATION: 29001 Solon Rd., Solon, OH

AVAILABLE: 8,640-32,000 contiguous SF

UNIT:	<u>Unit H</u>	<u>Unit I</u>	<u>Unit K</u>	<u>Unit O</u>	<u>Unit P</u>
SPACE AVAILABLE:	12,800	6,400 SF	12,800	6,400	8,640
WAREHOUSE SF:	12,600	6,400 SF	11,400	6,000	8,640
OFFICE SF:	200	0	1,400	400	
DOCKS:	2	0	1	2	3
DRIVE-INS:	0	2	4	0	0

CONSTRUCTION: Masonry and pre-cast concrete

YEAR BUILT: 1972

ZONING: I-2 Industrial Manufacturing

CEILING CLEARANCE: 20' clear

TRUCK DOCKS: 8

DRIVE INS: 6 (3 Drive- throughs). Oversized doors.

COLUMN SPACING: 32' x 40'

FLOORS: Concrete

BUILDING PARKING: Ample

SPRINKLERED: Yes

HEAT: Overhead Gas

LIGHTING: Metal Halide, Fluorescent

ELECTRIC POWER: 240 Volt/200 Amps/3 Phase

LEASE RATE: \$4.25/SF NNN

SECURITY SYSTEM: Yes.

CONTACT:

David R. Hexter, SIOR 216-831-3310 x140 dhexter@naidous.com

Jeffrey A. Calig, CCIM 216-831-3310 x210 jcalig@naidous.com



Commercial Real Estate Services, Worldwide.

Business Property Specialists, Inc., Broker

This information has been secured from sources we believe to be reliable, but we make no representations or warranties, expressed or implied, as to the accuracy of the information. References to square footage or age are approximate. Buyer must verify the information and bears all risk for any inaccuracies.